

# Cat® C15

## Diesel Generator Sets



Engine Model	Cat® C15 In-line 6, 4-cycle Diesel
Bore x Stroke	137 mm x 171 mm (5.4 in x 6.8 in)
Displacement	15.2 L (928 in³)
Compression Ratio	16.1:1
Aspiration	Turbocharged Air-to-Air Aftercooled
Fuel Injection System	MEUI
Governor	Electronic ADEM™ A4

Image shown might not reflect actual configuration.

Model	Standby	Prime	Emission Strategy
DE550E3	550 kVA, 440 ekW	500 kVA, 400 ekW	EU3a – Certified Emissions

### PACKAGE PERFORMANCE

Performance	Standby	Prime
Frequency	50 Hz	
Genset Power Rating	550 kVA	500 kVA
Gen set power rating with fan @ 0.8 power factor	440 ekW	400 ekW
Fuelling strategy	EU3a – Certified Emissions	
Performance Number	EM1247	EM0430
Fuel Consumption		
100% load with fan, L/hr (gal/hr)	116.7 (30.8)	108.8 (28.7)
75% load with fan, L/hr (gal/hr)	92.0 (24.0)	85.6 (22.6)
50% load with fan, L/hr (gal/hr)	65.7 (17.3)	61.1 (16.1)
25% load with fan, L/hr (gal/hr)	37.0 (9.7)	34.6 (9.1)
Cooling System <sup>1</sup>		
Radiator air flow restriction (system), kPa (in. Water)	0.12 (0.48)	
Radiator air flow, m³/min (CFM)	476 (16809)	
Engine coolant capacity, L (gal)	20.8 (5.5)	
Radiator coolant capacity, L (gal)	34 (8.9)	
Total coolant capacity, L (gal)	54.8 (14.4)	
Inlet Air		
Combustion air inlet flow rate, m³/min (CFM)	35.9 (1269.4)	35.0 (1237.4)
Max. Allowable Combustion Air Inlet Temp, °C (°F)	48 (118)	47 (116)
Exhaust System		
Exhaust stack gas temperature, °C (°F)	484.2 (903.6)	471.3 (880.4)
Exhaust gas flow rate, m³/min (CFM)	95.8 (3383.6)	91.4 (3226.7)
Exhaust system backpressure (maximum allowable), kPa (in. Water)	10.0 (40.0)	10.0 (40.0)
Exhaust Rejection		
Heat rejection to jacket water, kW (BTU/min)	165 (9374)	153 (8681)
Heat rejection to exhaust (total), kW (BTU/min)	426 (24213)	400 (22769)
Heat rejection to aftercooler, kW (BTU/min)	126 (7171)	118 (6712)
Heat rejection to atmosphere from engine, kW (BTU/min)	66 (3767)	59 (3366)
Emissions (Nominal) <sup>2</sup>		
NO <sub>x</sub> , mg/Nm³ (g/hp-hr)	1634.6 (3.5)	1470.6 (3.2)
CO, mg/Nm³ (g/hp-hr)	279.8 (0.6)	260.8 (0.6)
HC, mg/Nm³ (g/hp-hr)	10.1 (0.0)	13.0 (0.0)
PM, mg/Nm³ (g/hp-hr)	11.5 (0.0)	12.8 (0.0)

Alternator <sup>3</sup>			
Voltages	415V	400V	380V
Motor Starting Capability @ 30% Voltage Dip	1391 skVA	1291 skVA	1165 skVA
Current, amps	Standby: 765A, Prime: 696A	Standby: 794A, Prime: 722A	Standby: 830A, Prime: 722A
Frame Size	A2985L4	A2985L4	A2985L4
Excitation	SE	SE	SE
Temperature Rise, °C (°F)	Standby: 163°C, Prime: 125°C	Standby: 163°C, Prime: 125°C	Standby: 163°C, Prime: 125°C

## WEIGHTS & DIMENSIONS

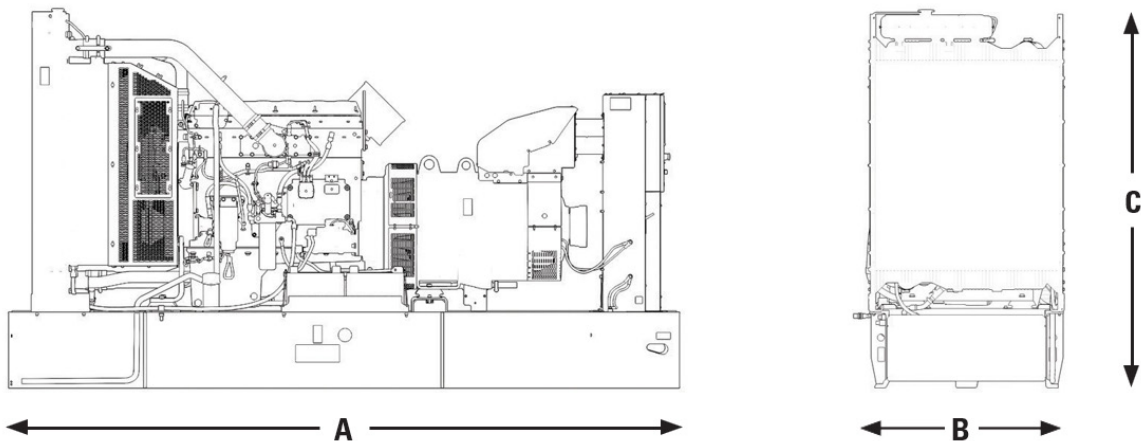

Length "A" mm (in)	Width "B" mm (in)	Height "C" mm (in)	Dry Weight kg (lb)
3830 (151)	1130 (44)	2255 (89)	3700 (8157)

**Note:** General configuration not to be used for installation. See general dimension drawings for detail.

### APPLICABLE CODES AND STANDARDS:

AS1359, IEC60034-1, ISO 3046, ISO 8528, NEMA MG1-33, EAC,CE,UKCA.

**Note:** Codes may not be available in all model configurations. Please consult your local Cat Dealer representative for availability

**STANDBY:** Output available with varying load for the duration of the interruption of the normal source power. Average power output is 70% of the standby power rating. Typical operation is 200 hours per year, with maximum expected usage of 500 hours per year.

**PRIME:** Output available with varying load for an unlimited time. Average power output is 70% of the prime power rating. Typical peak demand is 100% of prime rated kW with 10% overload capability for emergency use for a maximum of 1 hour in 12. Overload operation cannot exceed 25 hours per year

**RATINGS:** Ratings are based on SAE J1349 standard conditions. These ratings also apply at ISO 3046 standard conditions.

### DEFINITIONS AND CONDITIONS

<sup>1</sup> For ambient and altitude capabilities consult your Cat dealer. Air flow restriction (system) is added to existing restriction from factory.

<sup>2</sup> Emissions data measurement procedures are consistent with those described in EPA CFR 40 Part 89, Subpart D & E and ISO8178-1 for measuring HC, CO, PM, NO<sub>x</sub>. Data shown is based on steady state operating conditions of 77° F, 28.42 in HG and number 2 diesel fuel with 35° API and LHV of 18,390 BTU/lb. The nominal emissions data shown is subject to instrumentation, measurement, facility and engine to engine variations. Emissions data is based on 100% load and thus cannot be used to compare to EPA regulations which use values based on a weighted cycle.

<sup>3</sup> Generator temperature rise is based on a 40° C ambient per IEC60034-1.

[www.cat.com/electricpower](http://www.cat.com/electricpower)

©2026 Caterpillar  
All Rights Reserved.

Information contained in this publication may be considered confidential. Discretion is recommended when distributing. Materials and specifications are subject to change without notice. CAT, CATERPILLAR, LET'S DO THE WORK, their respective logos, "Caterpillar Corporate Yellow," the "Power Edge" and Cat "Modern Hex" trade dress as well as corporate and product identity used herein, are trademarks of Caterpillar and may not be used without permission.